

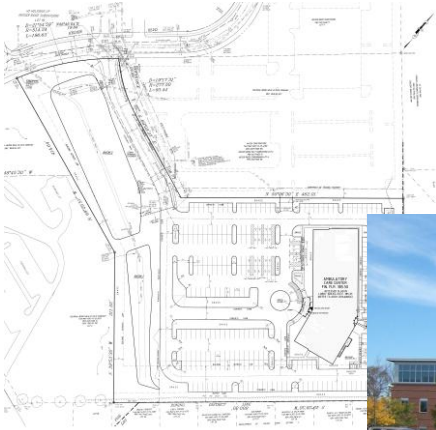

STACKHOUSE BENSINGER INC.
330 Revere Boulevard, Sinking Spring, PA 19608



This ambulatory care facility project was prepared for Reading Hospital and Medical Center. It includes a 75,000 square foot care facility and a 25,000 square foot basement for mechanical operations. The parcel size is approximately 11 acres and borders the Keiser Ridge office complex and Keiser Boulevard to the north and west. The site contains public water and sewer. This project created over 400 parking spaces and has access to Keiser Boulevard to the west. The project scope contained the following services:

- Site Planning
- Vehicular and Pedestrian Circulation Patterns
- Parking Layout
- Storm Drainage & Erosion and Sediment Control
- Grading & Landscaping
- Utility Design & Site Lighting
- Preliminary and Final Land Development Plans
- Access Management
- Construction Documents
- Municipal Approval

A traffic impact study was prepared for this project, and the level of service degradations were identified at intersections around the site. The study noted the necessary upgrades to the transportation network.

The client then donated sufficient funds to mitigate these degradations along the transportation network and gained project approval from the municipality.

Reading Hospital Ambulatory Care Facility Spring Township, PA